



Notification Letter

Date: February 24, 2021

Site: Chiswick, Township of Chisholm

Subject: New 36.6-Meter Tower Installation for Fixed Wireless Internet Service

As part of a project initiative by Blue Sky Net, Spectrum Telecom Group proposes to construct a 36.6 meter (120-foot) high, self-support tower site on municipal land located at 2847 Chiswick Line in the Township of Chisholm. The proposed wireless site will be a key component in a network designed to extend high-speed Internet and related services to the public and business users in the area. You are receiving this notification because you own property within the specified notification area of the proposed site.

The Township of Chisholm requires that the following information be sent to residents in the area as part of its notification process. This process allows residents an opportunity to provide comments and feedback so the Municipality can properly assess impact and determine whether the project is in the best interests of the community as a whole.

- 1. Purpose of the Structure:** The proposed tower mast will support antennas and wireless equipment designed to provide fixed high-speed Internet access and related services to residents and business users located in the Chiswick area of the Township.

This structure will replace an existing 68-foot antenna mast on the same property and will provide better Internet service coverage in the area. In addition, upgraded equipment will be installed on the tower to improve the performance of service connections to existing and new users in the area.
- 2. Location:** The proposed mast will be constructed on municipal land located behind the Township Municipal office at 2847 Chiswick Line (property identifier: PIN 49190-0257). The proposed tower will be set back from the roadway approximately 100 meters. The location is shown on Attachment 1. The approximate geographical coordinates of the site are: *Latitude 46.11424 degrees; Longitude -79.17769 degrees.*
- 3. RF Exposure Levels:** RF output power of the networking and backhaul radio equipment proposed is relatively low. Consequently, the tower and its antennas will not expose the public to any harmful levels of radio frequency (RF) exposure whatsoever and will be installed and operated on an ongoing basis so as to comply with Health Canada's Safety Code 6. This code establishes safety guidelines for the protection of the public against the effects of radio frequency fields.

The level of RF exposure experienced by an individual standing on the ground near the base of the tower is calculated to be less than one percent of the maximum limit as specified in Safety Code 6.
- 4. Public Access Control:** Electronic equipment will be mounted at an elevated level on the antenna mast as well as inside a secured shelter which is not accessible to the general public. The tower will be enclosed with an anti-climb shield to help prevent unauthorized climbing of the structure.

5. **Site Environmental Status:** The proposed antenna mast and equipment shelter installation, having minimal environmental impact, does not require an environmental assessment as the facility meets the exclusion criteria as specified in the Canadian Environmental Assessment Act.
6. **Support Mast and Antenna System:** A profile of the tower is included as Attachment 2. Internet services will be extended to customer locations over specialized distribution antennas. A picture of a typical distribution antenna (which would be attached near the top of the mast) is shown on Attachment 3, figure 1.

The tower will also support two 1.8-meter (72") maximum diameter dish-type antennas (similar to that shown on Attachment 3, figure 2). This antenna will provide backhaul connectivity to the Internet and Spectrum Telecom Group's wide-area telecommunications network

Images of the actual tree line near the site, with a simulated image of the tower superimposed, is also shown on Attachment 4 (photos 1 and 2). These images will provide a good idea of what the tower would look like on the landscape.

7. **Aviation Obstruction Marking:** Spectrum Telecom Group proposes not to equip the tower with white, red, or flashing aviation obstruction lighting as the structure likely does not pose a significant threat to aircraft navigation in the area. However, Spectrum Telecom Group will conform to any aeronautical safety requirements that may be mandated by Transport Canada or NAV Canada. Typically, lighting or paint marking scheme is not required on smaller towers such as the one proposed unless it's located close to an aerodrome.
8. **Installation Practices and Structural Adequacy:** The tower proposed is commonly used throughout the region for various telecommunications applications and is designed to support the intended antenna load with a significant safety margin. The tower and associated antennas will be installed in accordance with CSA Standard S37, manufacturer's specifications, and established installation practices.
9. **Land Use Requirements:** The site chosen has been coordinated with the Township of Chisholm and concurrence from the Municipality is required before construction can begin. Spectrum Telecom Group will comply with any applicable local land-use requirements that we are made aware of.
10. **Contact Information:** This notice initiates an invitation to the public to provide written comments to Spectrum Telecom Group about this proposal by **April 9th, 2021**. Please mail, e-mail (preferred), or fax your comments to the following address:

Spectrum Group
132 Imperial Road,
North Bay, Ontario, P1A 4M5
Attn: Mr. Wayne Lynch

E-mail: consultation@spectrumtelecom.ca
Fax: (705) 474-6192
Phone: (705) 474-6368, ext. 214
Toll Free: 1-800-267-8560

The Land Use Authority (LUA) for the area is the Corporation of the Township of Chisholm. Contact information for the LUA is as follows.

Township of Chisholm
Attention: CAO Clerk-Treasurer
2847 Chiswick Line, RR # 4
Powassan, ON P0H 1Z0

Phone: (705) 725-3526, ext. 203

Fax: (705) 724-5099

Email: j.leblond@chisholm.ca

Web: www.chisholm.ca

11. **Acknowledgement of Concerns:** Any written comments from the public will be promptly acknowledged and responded to within two to three business days. Any comments received will be forwarded to the Municipality along with the corresponding response.
12. **Public Meeting:** A public meeting is scheduled by the Municipality for **April 13th, 2021 at 7:00 PM**. This meeting will be an opportunity to learn more about the project and also to voice any comments or concerns you might have. Due to COVID-19 safety measures currently in place, attendance by the public is restricted to teleconference access only. If you wish to participate, the access numbers are as follows.

Dial-in Number: 1-855-343-6177

Conference ID: 5125690#

Kindly review this proposal and, if you wish to forward any comments, please do so within the time period outlined above.

Thank you.

*Wayne Lynch
Project Administrator
Spectrum Telecom Group*

Blue Sky Net

Blue Sky Net helps municipalities in Northeastern Ontario to develop information technology applications as well as assist with the rollout of enhanced telecommunications infrastructure. This is facilitated by bringing together service providers, potential users, and government programs with a view to creating a viable business case and overcoming the many challenges associated with developing broadband infrastructure in rural communities. More information can be found on the Blue Sky Net website:

<https://blueskynet.ca>

Spectrum Telecom Group

Spectrum Telecom Group Ltd. is a wireless, two-way radio, ISP, and broadband solutions company that provides integrated telecommunications solutions and networks for residential, business, and government clients throughout the Province of Ontario. More information can be found on the Spectrum Group website: <https://spectrumtelecom.ca/company/about-us/>

Proposed Chiswick Tower Site Location



Property Description: 2847 Chiswick Line, behind the municipal office building, PIN 49190-0257

Site coordinates: Lat 46.11424 °; Long. -79.17769 °

Elevation: 965 feet (294 meters) AMSL (approximate)

Tower Height: 120 feet (36.6 meters) AGL

Leg	50 KSI	A	SR 2-1/4" Ø	B	C	D	E	F	G	SR 1" Ø
Diagonal	44 KSI	SR 1" Ø	SR 2-1/4" Ø	SR 3/4" Ø	SR 5/8" Ø					
Horizontal	44 KSI	SR 1" Ø	(3)-5/8							
Brace Bolts	A325									
Face Width	4.0'	8 @ 2.5'		80 @ 1.3'						
Panel Height # Panels										

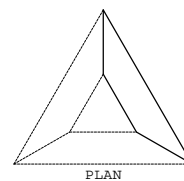
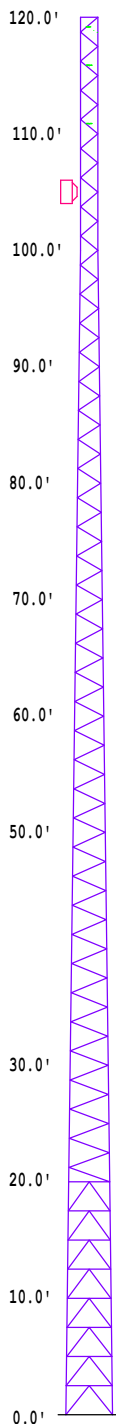

- NOTES:**
1. Working Stress DESIGN (UNfactored)
 2. TYPICAL DESIGN NOT FOR CONSTRUCTION
 3. MAX T/T +/-1.55 DEGREES

MATERIAL LIST

NO	TYPE
A	SR 2-1/2" Ø
B	SR 1-3/4" Ø
C	SR 1-5/8" Ø
D	SR 1-1/2" Ø
E	SR 1-3/8" Ø
F	SR 1-1/4" Ø
G	SR 1-1/8" Ø

The design and dimensions of the actual tower installed may differ slightly from that which is shown in this document.

TOTAL FOUNDATION LOADS

H=3.63k
 V=10.16k
 M=239.28k-ft
 T=0.60k-ft

INDIVIDUAL FOOTING LOADS

H=2.11k
 V=72.46k
 U=-65.66k



Head Office:
 505 Froid Road
 Sudbury, Ontario P3C 5A2

Date: 12 February 2021

Location: Chiswick Site

Total Height: 120.00'

Tower Height: 120.00'

Standard: CSA S37

Images of Antenna Tower Attachments

Figure 1: Internet Distribution Antenna (one of four located near tower top)



Dimensions: Length 33 inches. X width 6.5 inches

Figure 2: Dish Antennas for Internet Backhaul Link (one of two)



Mounted above tower midpoint. Diameter: 1 at 48", 1 at 72"

Images of a Similar Tower Structure

Photo 1: Simulated Image of Tower Mast Superimposed on Landscape (photo taken on Chiswick Line about 400 meters east of site looking west)



Photo 2: Simulated Image of Tower Mast Superimposed on Landscape (photo taken on Chiswick Line about 400 meters west of site looking east)

